

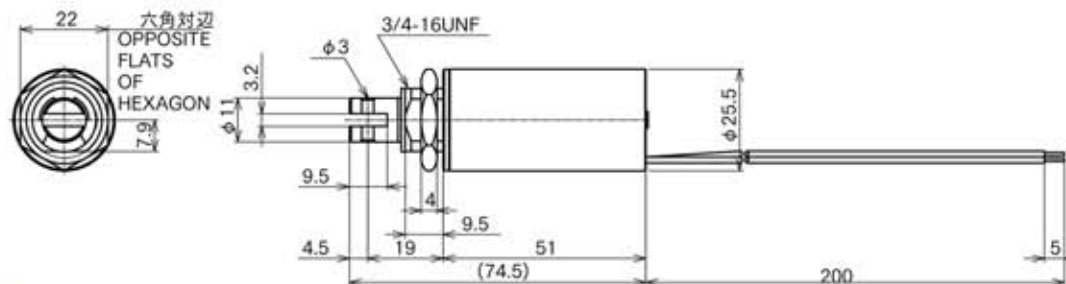

外形寸法
Dimensions

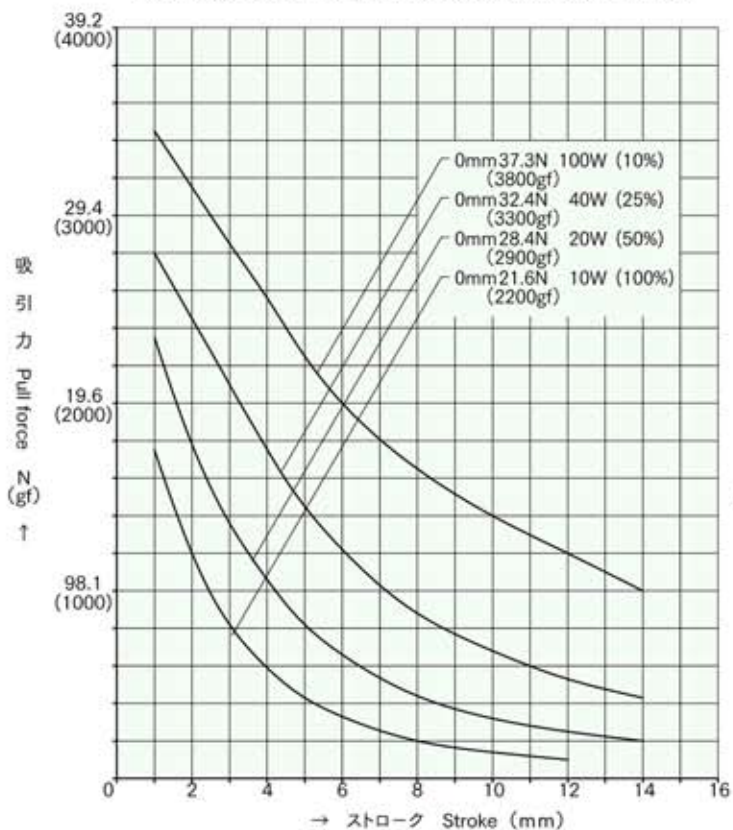

■ ストローク / 吸引力特性
Stroke and Pull Force Characteristics



■ 容量 / 吸引力特性
Power and Pull Force Characteristics

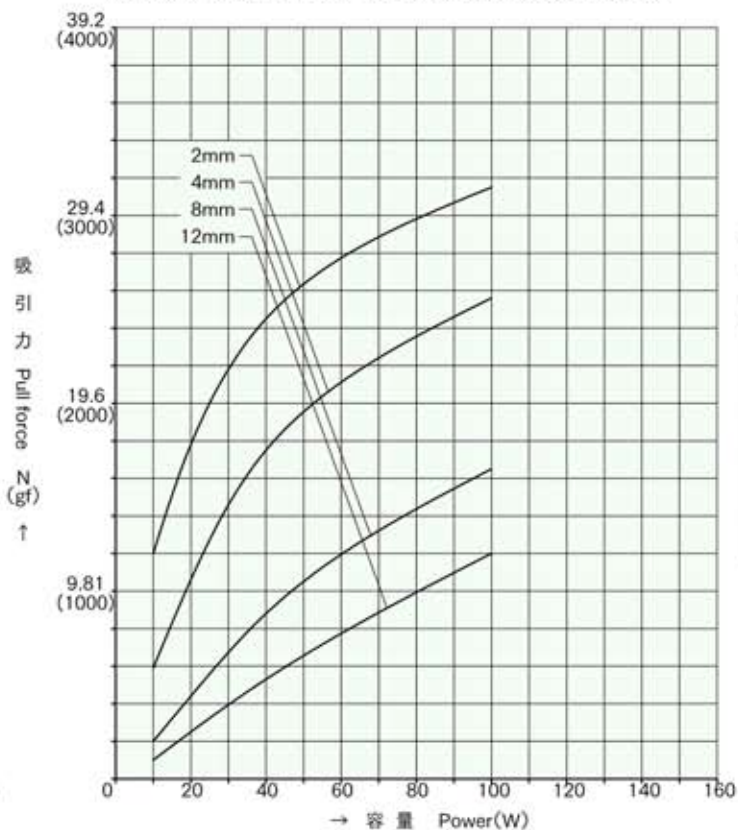

標準コイル表 連続定格 10W
Standard Coil Specifications
Cont. rating 10W

電圧 (V) Voltage	抵抗 (Ω) Resistance	電流 (mA) Current
6	3.6	1667
12	14.4	833
24	57.6	417

● 総重量 : 180.0g
Total weight